



houndsy

Quick Start Guide

1

Remove and open the white box underneath the Quick Start Guide to find the bowl(s), legs, stickers, and wall anchor packed for your order.

2

Open the inner kibble dispenser box. Remove the styrofoam packaging on top of the kibble dispenser.

3

After opening the inner kibble dispenser box, unlock the lid by turning both knobs **counter-clockwise**. Put the lid aside.

4

Grab an edge of the lid opening and lift the kibble dispenser straight up and out. You can also lay the box on its side and slide it out. Be careful, as the base weighs ~25 lbs.

5

Place the kibble dispenser on a flat, clean surface and screw the (4) angled legs into the threaded inserts. Place the dispenser upright.

6

Use the provided wall anchor to secure the kibble dispenser to the wall.

For additional support please call (225) HOUNDSY (468-6379) or email hello@houndsy.com





houndsy

Quick Start Guide

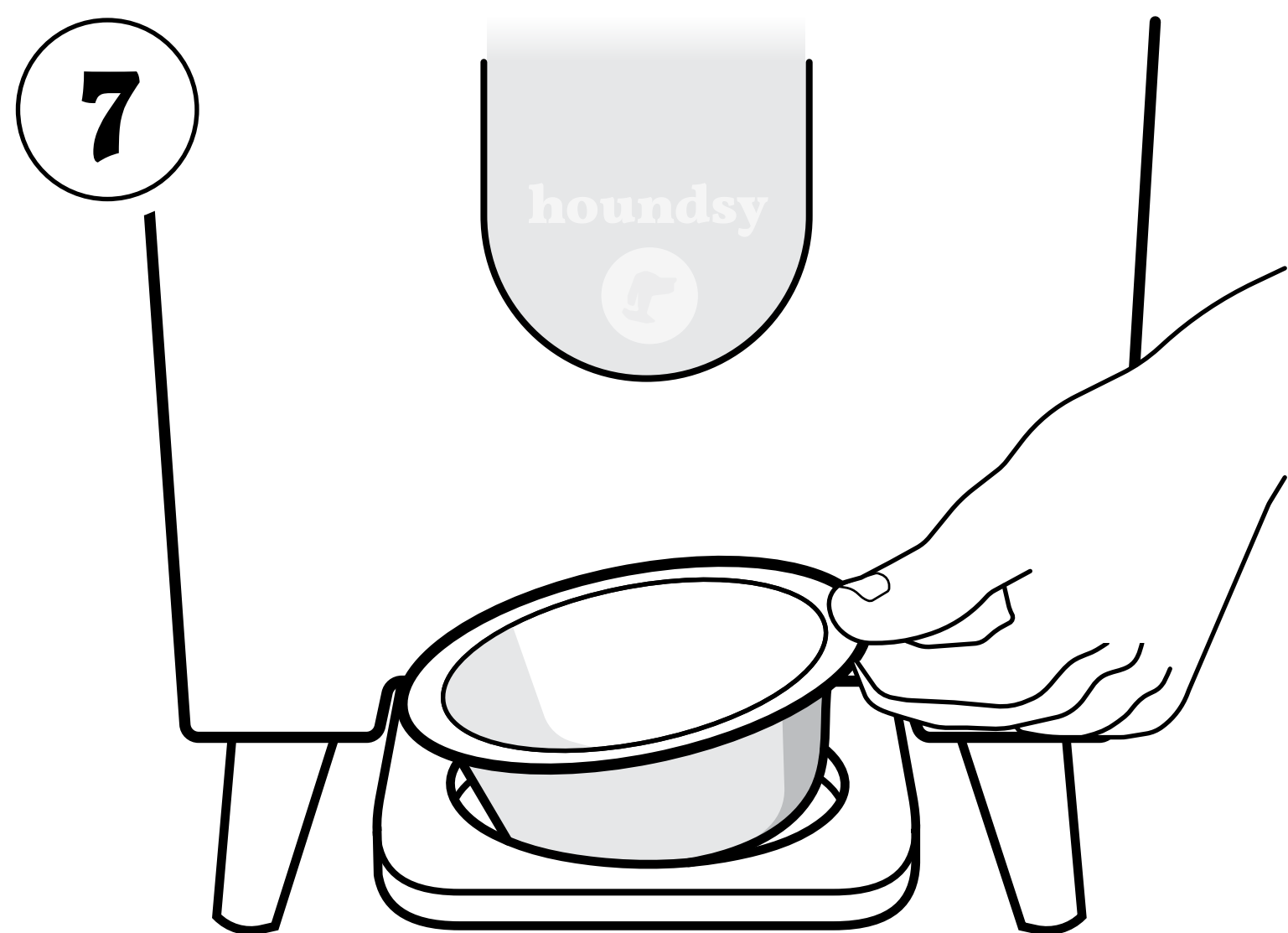

Place the provided bowl into the drawer opening. **Warning: never retract the drawer without a bowl in it or kibble will fall out.**

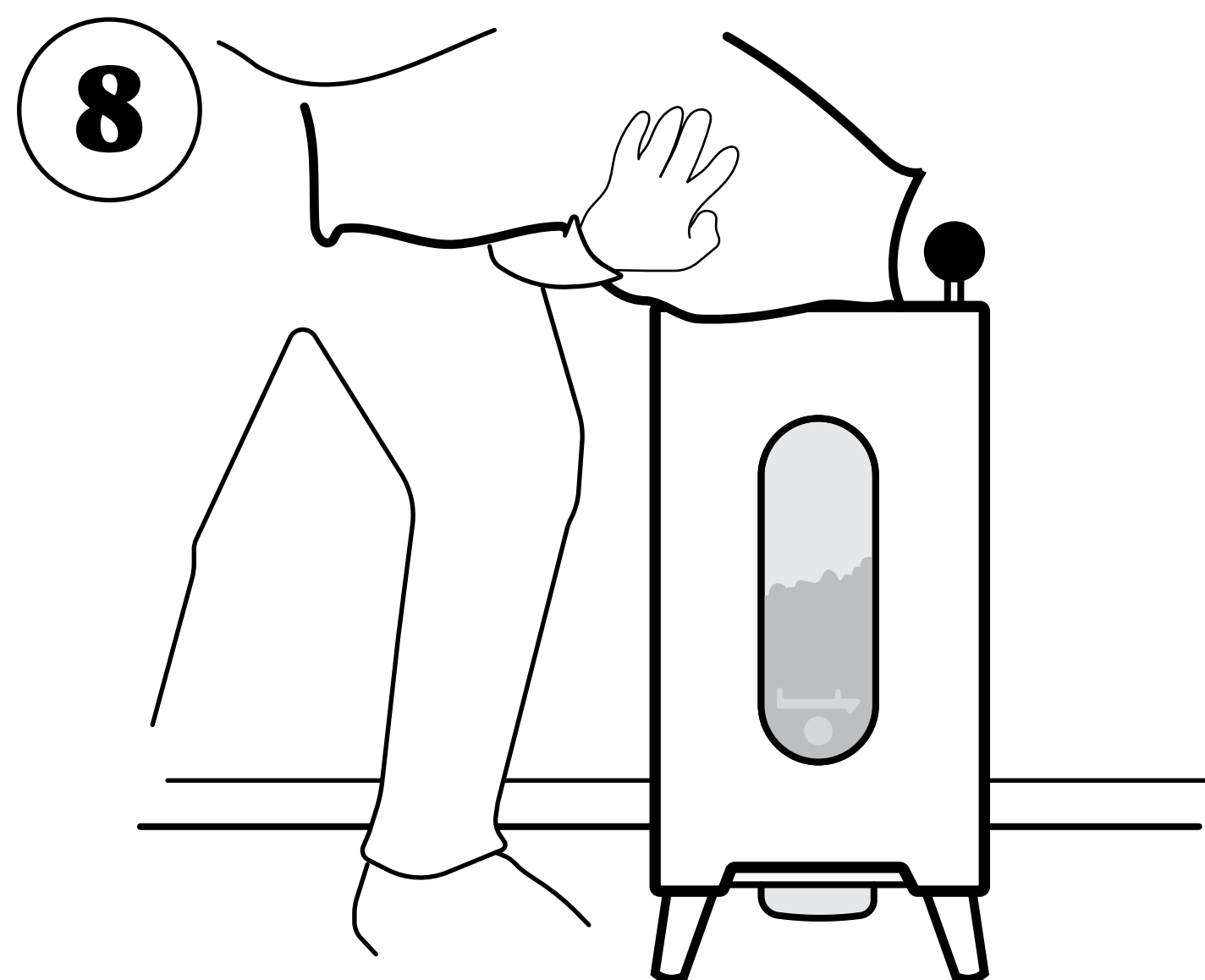

Pour kibble into the storage bin, close the lid, and turn the knobs clockwise to lock the lid in place.

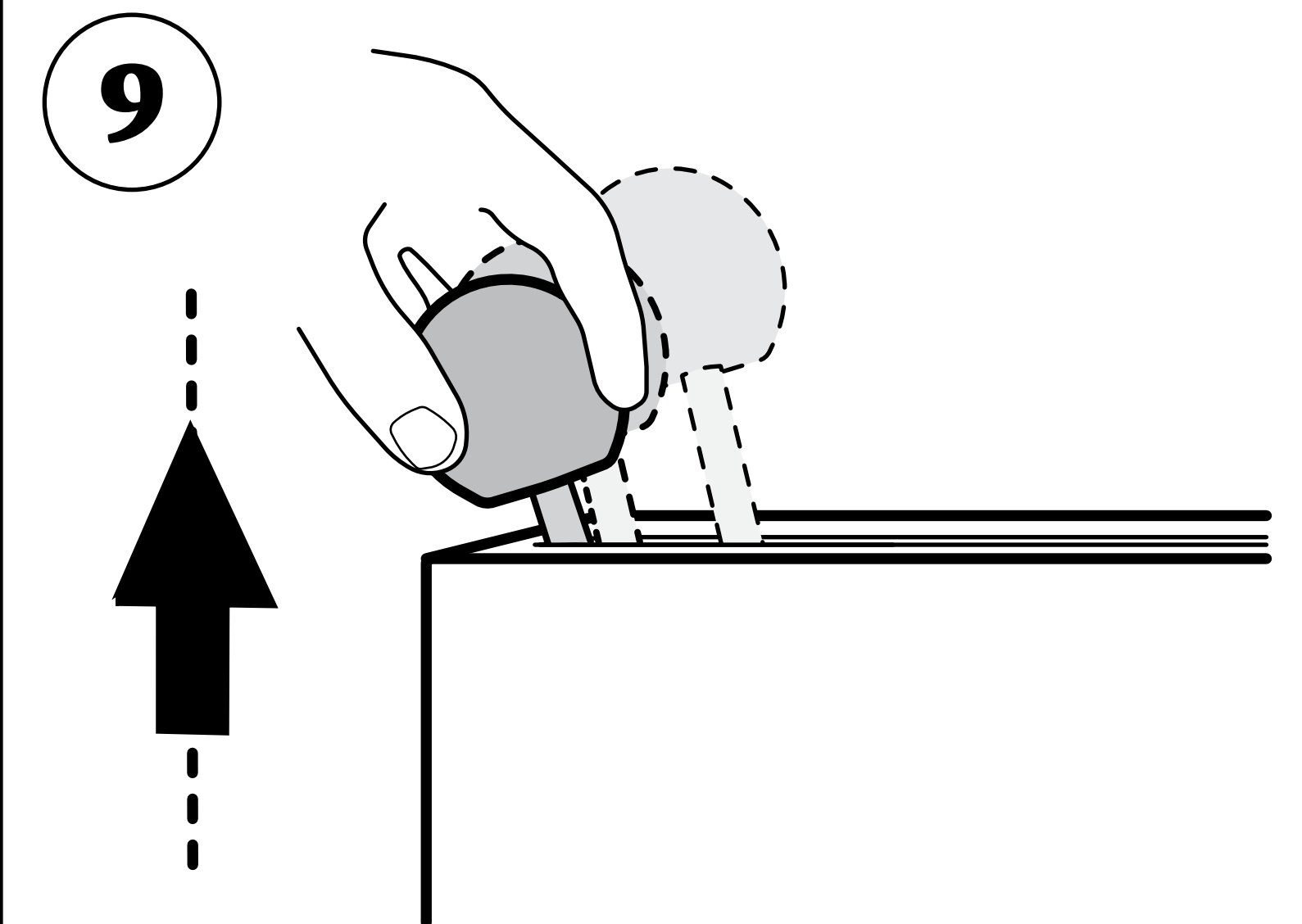

The kibble dispenser has an auto-locking mechanism to mitigate unintentional servings. To operate it you have to lift the knob up before moving it.

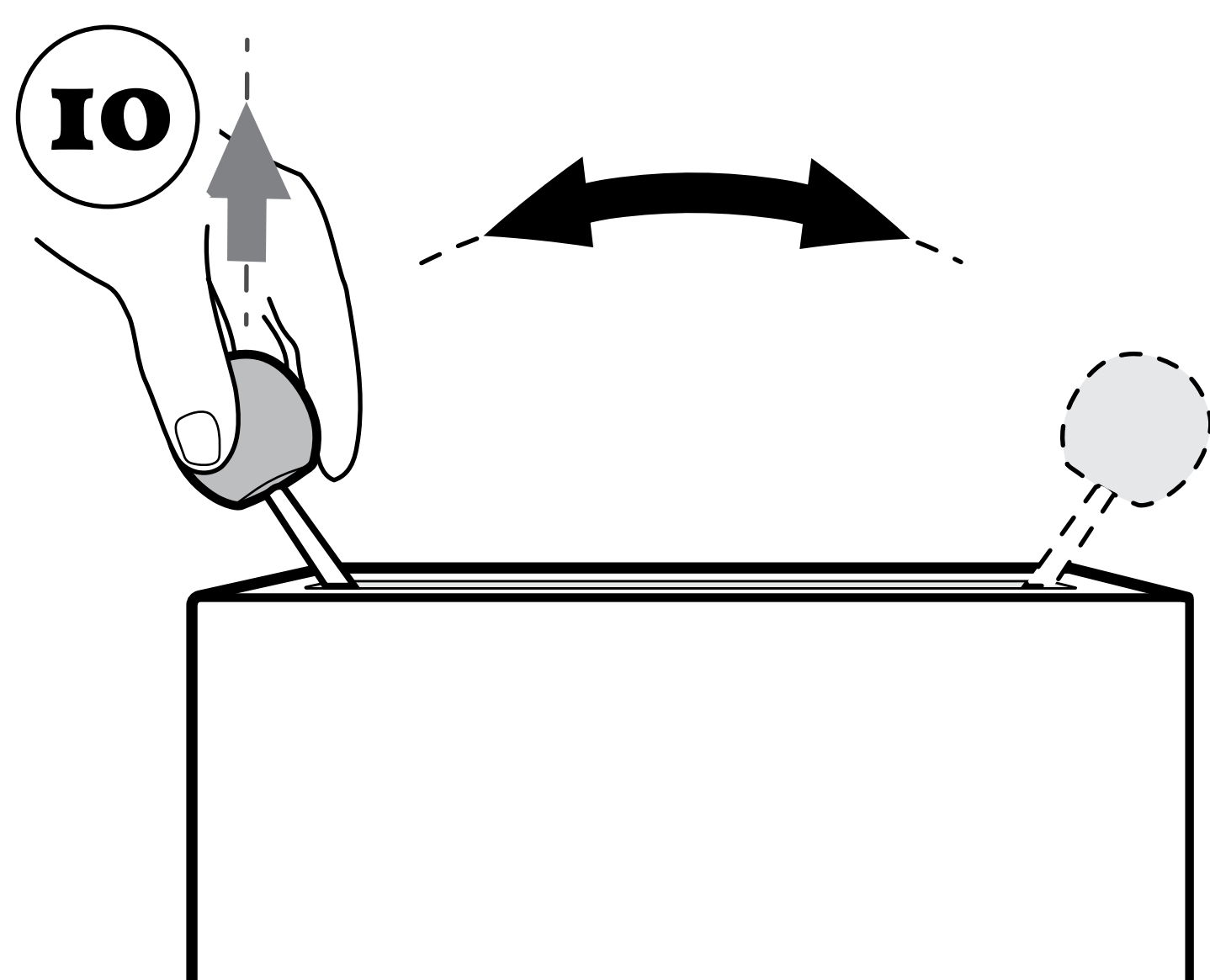

After lifting the knob, push or pull the knob to open or close the drawer. Keep the drawer open for now.

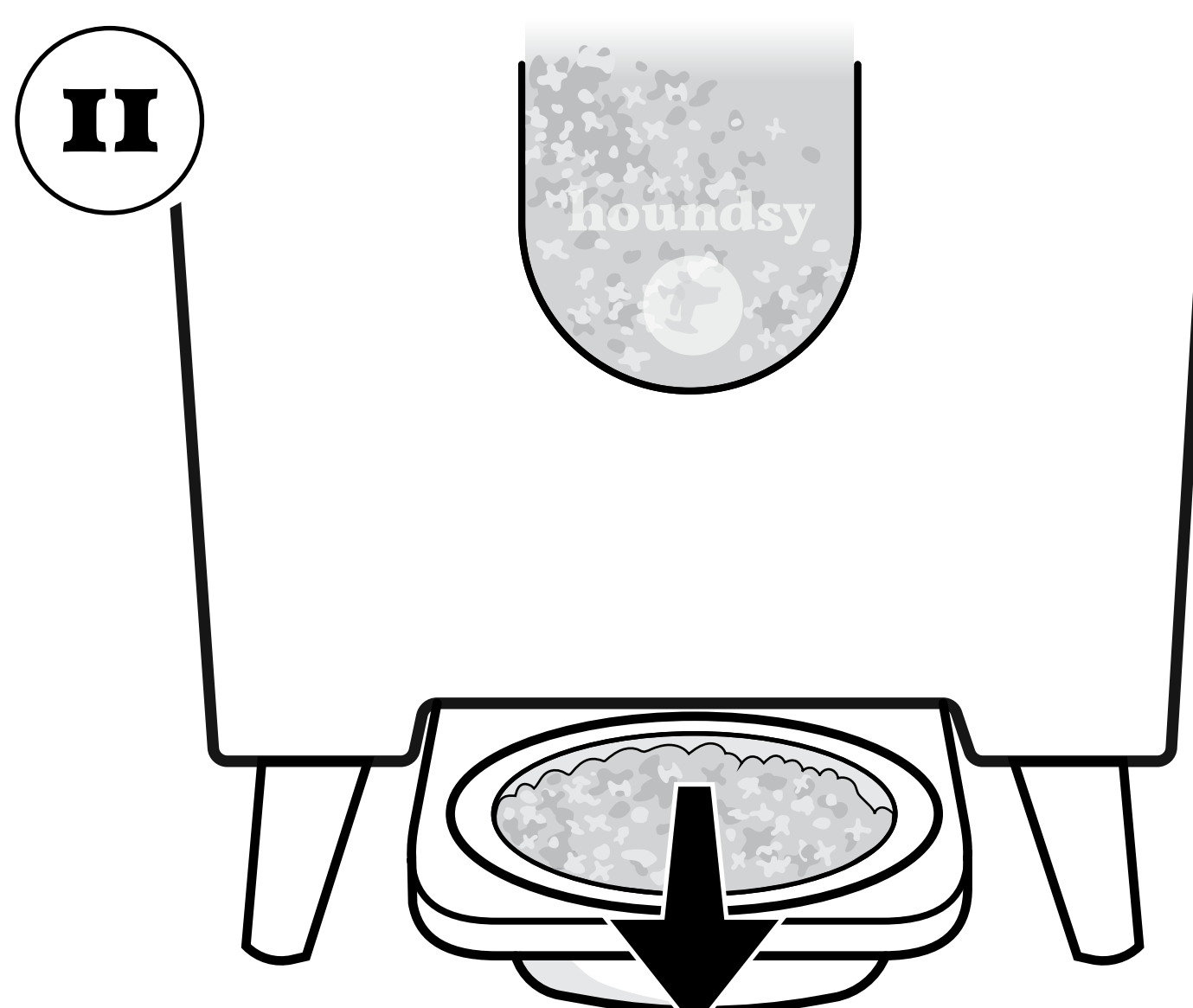

Retract the drawer into the storage bin, wait for the kibble to fall, and then release the drawer - now full of kibble! **Warning: never retract a full bowl of kibble back into the storage bin.**

For additional support,
please call (225)
HOUNDSY (468-6379)
or email
hello@houndsy.com